



Diamonds Are Forever

by Benetti Yachts and Evan K. Marshall/Usonia V

The name's Staluppi, John Staluppi. If a boat is named after a Bond film, then it must be John Staluppi's boat – it's almost a personal signature, expressing one of the individual preferences of the legendary American tycoon, although for some time now he has been involved in a stronger, more overwhelming passion: period cars. John Staluppi has cultivated his passion for classic cars for many years, putting together his own private collection of fabulous vehicles that culminated in the creation of the incredible Cars of Dreams Museum. It's a remarkable, unique collection of numerous cars from the 1950s, 1960s and 1970s, all beautifully preserved in the immaculate splendour of their impeccably polished paintwork and glittering mirror-effect chrome plating. With their sleek lines and bright colours, these cars are fascinating metal sculptures, magically intact examples of technological and artistic beauty. They're certainly worth a lot of money, but more importantly they are a great historical treasure and an immense cultural asset, safeguarded thanks to John Staluppi. Nonetheless, other genres of artwork move

him as well, and boats play a notable part here. Presumably for reasons of space, the considerable size of these seaborne masterworks make it impossible to put them together in a collection, and this is probably why John Staluppi likes to change his boat frequently. Over the years, he has had a large number of custom motor yachts built, and they have entered yachting legend for all time, standing out for their ultra high speed performance, which was in turn made possible by the cutting-edge technologies that the enlightened Owner explicitly requested from the best shipyards. Recently, however, John and Jeanette Staluppi have changed course and have become more interested in the production of custom motor yachts for tranquil cruises, typified by the size of the interiors and the magnificence of the fittings. For their next boat, the American couple put their faith in the Italian shipyard Benetti Yachts: the project for Diamonds Are Forever, as this unique "Quad Deck Design" motor yacht is called, was signed in December last year and the new motor yacht will be launched in August next year. ➤

On this and the following pages: the aesthetics of the exterior make for an elegant, attractive look; a contemporary interpretation of the most exclusive luxury yacht design, whose softly compact and dynamically sleek lines instantly catch the eye.







Two renders of the sun deck with bar, lounge area and jacuzzi. Below, left, a render of the upper aft deck with the glass doors of the indoor-outdoor area in the closed position.

The yacht will be delivered to John and Jeanette in late summer and then, in early autumn of the same year, she will be presented at FLIBS 2011, the 52nd Fort Lauderdale International Boat Show in Florida.

The main dimensional and technical data

Bearing the code FB 253, the historic code of the shipyard and a number specific to the build, the new yacht is based on naval architecture and engineering devised in-house by the technical department of Azimut-Benetti. High-resistance steel was used for the hull and light aluminium alloy for the superstructure. The vessel's build complies with the classification rules of Lloyd's Register of Shipping (LRoS) for Maltese Cross 100A1 SSC, Yacht Mono, G6, LMC and UMS. In terms of dimensions, the new Diamonds Are Forever has a total length of 60.80 metres, equivalent to 199 feet 6 inches, with a length at the waterline of 50.50 metres, equivalent to approximately 165 feet 6 inches. Its total width is 10.60 metres, equivalent to 34 feet 9 inches. The maximum draft of the hull is



Below, right, a render of the main aft deck with the lounge area and the glass doors that lead to the salon.

approximately 3.20 metres, or 10 feet 6 inches, while load displacement is 830 tons, equivalent to 1,832,230 pounds. The hull of the new yacht is of the displacement type with a bulbous bow and a longitudinal skeg running from amidships to the stern. It is equipped with a VT 140 tunnel bow thruster from VT Naiad Marine Systems and a 160-kW electric motor, along with a QC 1800 XT stabiliser system from Quantum, with on-navigation extendable active fins and an at-anchor zero speed function. The stabiliser system is configured with a pair of lateral fins positioned amidships and an electro-hydraulically controlled drive system. It is operational both at anchor and when underway; for the latter, the design has been optimised for a speed of 12 knots, deliberately corresponding to the economic long-range cruising speed. Two Caterpillar CAT 3512B Di-TTA series, rating C, high-displacement V12 cylinder turbodiesel engines are to be installed in the machine room of the new Diamonds Are Forever. Each engine has a total cylinder capacity of 58.6 litres, equivalent to 3576 cubic inches, and maximum power of 1850 BHP, equivalent to 1380 bkW, supplied at 1600 rpm. ➤





In Coupled to the ZF reduction gearboxes, the two engines are connected via stainless steel transmission shafts to a pair of five-blade, fixed-pitch Detra propellers produced to a custom design by Benetti Yachts. In terms of performance, the new yacht will be able to reach a maximum speed of 16 knots under medium load conditions, while with the engines at 85% of maximum power, it will be able to maintain a cruising speed of 15 knots. At the economy cruising speed of 12 knots, she will have an estimated range of 4800 nautical miles, thanks largely to the fuel tanks that contain 135,000 litres of fuel, equivalent to more than 35,700 US gallons. For their part, the freshwater tanks can hold 20,000 litres, equivalent to nearly 5,300 US gallons. They are constantly topped up by a desalination plant producing a sufficient daily quantity. Three tri-phase 50-Hz generators will be installed on the new Diamonds Are Forever, all based on 6-cylinder inline diesel generator motors by Northern Lights. The two main generators are M1276A1 models, each with a cylinder capacity of 12.5 litres, equivalent to 763 cubic inches, and each producing 200 kW/250 kVA at 1500 rpm. The emergency generator is an M1066A2 model, with cylinder capacity of 6.8 litres, equivalent to 414 cubic inches, producing 115 kW/144 kVA at 1500 rpm.

The equipment of the new boat will include two jet skis and a 4.20 m/13'9" rescue tender, which will be laid up in the open in the technical area on the fore main deck, while a waverunner and a 7.50 m/24'8" main tender with inboard drive and hydrojet propulsion will be laid up in the garage on the aft lower deck.

The solarium terrace of the new Diamonds Are Forever – in a raised position to aft on the sun deck – can also be transformed if necessary into a touch-and-go helipad, able to accommodate a 3,000-kg (over 6,600 lb) passenger helicopter.

A general overview of the new motor yacht

As with other Benetti yachts, a special advanced machining method has been used in the construction of the new Diamonds Are Forever. Based on high-precision laser cutting of steel and aluminium plate, it will prepare both the structural elements and the panels for the hull and superstructure, which will then be assembled using a special treatment to ensure maximum quality at the end of the welding and finishing processes. In addition, the design and construction of the new Diamonds Are Forever benefit from technical applications carefully chosen from among the best solutions available on the market.

For example, an advanced, innovative stabiliser system from the Quantum XT series - using extendable active fins - has been adopted for the yacht, making it possible to reduce roll while underway and to benefit from the performance of the zero speed system at anchor: a system more efficient than traditional designs using fixed or active non-retractable fins.

The extendable active fins have a variable structure, making it possible to extend the surface of the fin profile only when necessary, i.e. at anchor, while the fin size is reduced when sailing, thus diminishing drag and consequently maximising fuel consumption. In general, this system also makes it possible to install one pair of fins instead of the traditional pair of fins required for longer hulls.

For these reasons, stabilisers with extendable active fins are particularly suitable for large motor yachts with a low-resistance hull and a high service speed, exactly like the new Diamonds Are Forever. ➤

Diamonds Are Forever

In the main salon, the living and dining areas incorporate elegant loose furniture custom designed to ensure maximum comfort and visual impact: like other settings on board, they are of impressive richness and constitute the sumptuous epitome of classic refinement.



▲▼ The main salon





In the sky lounge a unique and spectacular automated indoor-outdoor dining area can be opened up towards the lounge to serve as an "indoor" dining area, but at the flick of a switch two sets of electrically powered glass doors separate it from the lounge and open it upwards the aft cockpit instantly creating an "outdoor" dining area.

Ensuring the best possible result requires the best possible organisational conditions, and these are provided by the well-coordinated collaboration between the numerous high-profile professionals working on the new yacht: Peter Thompson of Ocean Independence brokered the project, while the build is being managed from the Owner's side by Mike Britton and the Staluppis' current captain, Neil Duffy, and from Benetti's side by Nicola Nicolai Project Manager, Domenico Gavagnin interior project manager and Michele Guerrieri exterior designer. As usual with all the motoryachts in Benetti's FB Line, the concept design and exterior design for the new Diamonds Are Forever were devised by Stefano Natucci /Azimut-Benetti, delineating characteristics for the new yacht that have become an unmistakable, timeless modern classic, instantly recognisable as a trademark of Benetti motor yachts. The elegant aesthetics of the new Diamonds Are Forever offers a contemporary interpretation of the

exclusivity of luxury yachting, marked out by softly compact shapes and dynamically slim lines. The stand-out example of this is the new motor yacht's additional top deck, or rather an unusual fly bridge located above the sun deck, which forms a remarkable panoramic private deck. In fact, at the Owner's request, this space can be completely cut off from the routes and areas accessible to guests and crew, as it can only be reached via controlled access from the main staircase and the central elevator. Both of these provide access with a unique pop-up solution in an automated electrically powered glass lid. On board, in its magnificent, spacious interior layout, the new Diamonds Are Forever will accommodate up to 12 passengers in four vast guest staterooms, a huge VIP suite and the majestic Owners' stateroom. The yacht will also house up to 16 crew members in six snug crew cabins, a comfortable engineer's cabin and the large captain's cabin. ➤



Diamonds Are Forever

The VIP master stateroom is on the main deck in the VIP suite, which features a split-level layout and includes his and hers walk-in dressing rooms: this unique VIP master stateroom has large panoramic forward facing windows, like those in the Owner's master stateroom on the upper deck.



▲▼ The VIP cabin



The interior design and decoration of the new Diamonds Are Forever were created by Evan K. Marshall / Usonia V, as with some of the other motoryachts previously built for John and his wife Jeanette. The richness of the interiors is genuinely impressive, luxuriously epitomising classic refinement. All the loose furniture has been custom designed by Evan K. Marshall to ensure maximum comfort and visual impact. The foyers on each deck of the new Diamonds Are Forever showcase the central spiral staircase and the cylindrical glass elevator; each foyer features a different combination of marble and onyx floor inlays, with burl wall panels framed by gold and silver leaf inlays. On the main deck of the new yacht, the living and dining areas incorporate elegant pieces of loose furniture with design motifs inspired by the ship's name. In a departure from typical yacht furnishings, the main pieces of furniture inboard of the windows appear to be free-standing and supported only by mirrored legs embedded with small crystal studs. The back-lit centre design elements on each of the freestanding pieces are made of glittering Swarovski crystals set in a polished chrome and gold-plated surround. The lower deck layout of the new Diamonds Are Forever includes one twin stateroom and three double staterooms, two of which have walk-in wardrobes. The materials for the staterooms include elegant Madrona burl woods, gold and silver leaf inlays, rare marbles and onyx, and custom coloured and embossed leathers for the bulkhead. The layout of the new Diamonds Are Forever also includes two unique master staterooms, both with large, panoramic forward-facing windows: the VIP master stateroom and the Owners' master stateroom. The VIP master stateroom is on the main deck in the VIP suite, featuring a split-level layout and his and hers walk-in dressing rooms, an exercise room with adjoining sauna and a beauty salon with massage table. All of these spaces can be separated from the stateroom for use by other guests. The Owners' master stateroom is on the upper deck in the Owners' apartment, which occupies half of the upper deck and includes an office suite connected to the sky lounge, a master bathroom with "floating" vanities suspended from mirrored walls, and a dressing room that doubles as an elegant Owners' foyer or a private study. The upper deck of the new Diamonds Are Forever also includes the sky lounge, featuring a spectacular, unique automated indoor-outdoor dining area: the dining area can be fully opened up to the sky lounge as an "indoor" dining area, but at the flick of a switch two sets of electric doors separate it from the sky lounge and open it up to the aft cockpit, instantly creating an "outdoor" dining area. The living area of the sky lounge occupies the full beam of the boat: this space boasts a low bar and a grand piano, set in mixed tones of Birch burl woods with silver and gold leaf accents. In the Diamonds Are Forever's sky lounge, against custom back-lit glass and mirror diases in each of the four niched corners – inspired by the famous *Quattro Fontane* in Rome – there are four original sculptures showcasing John Staluppi's passion for the sculptures of the great Erté, pseudonym of Romain de Tiroff, the last great master of Art Nouveau and Art Déco. The work of this exceptional set and costume designer, graphic designer, fashion stylist, sculptor and jewellery designer is a constant throughout the last century. In all likelihood, the sculptures are from the America Series quartet, inspired by a profound faith in the American commitment to the values expressed by the titles of the sculptures: "Liberty", "Fearless and Free", "Peace" and "Justice". Created at the beginning of the 1980s by the imaginative talent of Erté at the age of 90, these four sculptures were produced using a bronze alloy casting technique, and they are part of a very limited edition. In the interiors of Diamonds Are Forever, diamonds are everywhere.

The layout of the lower deck includes one twin stateroom and three king-size staterooms, two of which have walk-in wardrobes; the materials used in the staterooms include elegant Madrona burl woods, gold and silver leaf inlays, rare marbles and onyx and custom coloured embossed leathers for the bulkhead.

Flaviano Perelli

Diamonds Are Forever

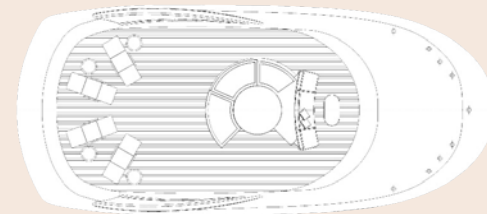

Top deck

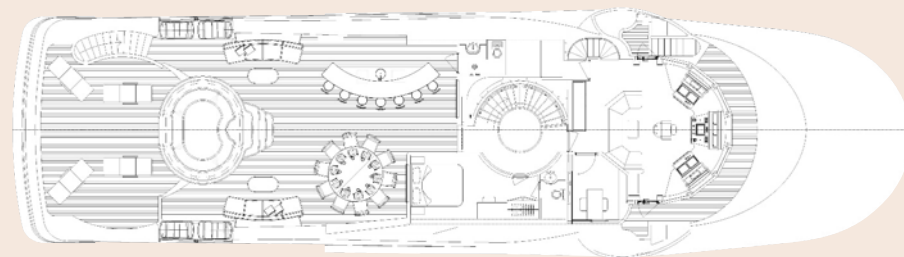

Sun deck

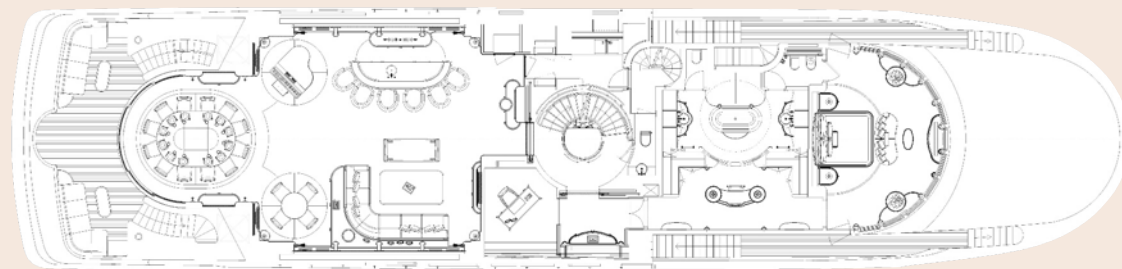

Upper deck

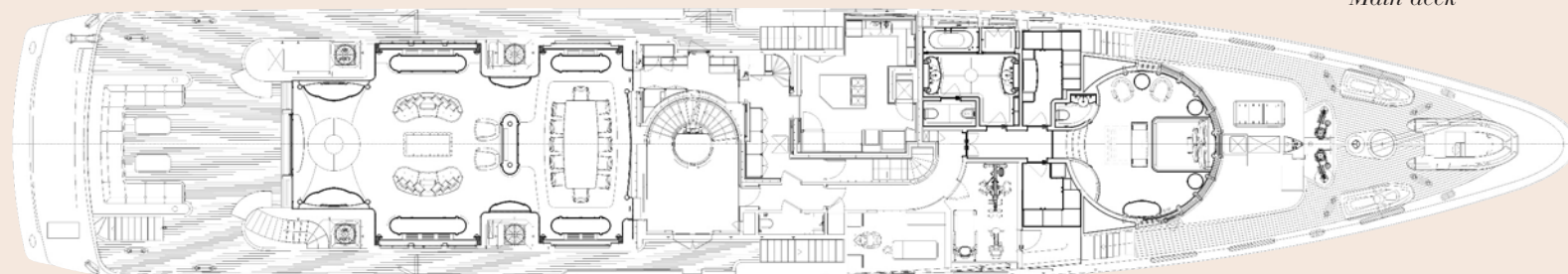

Main deck

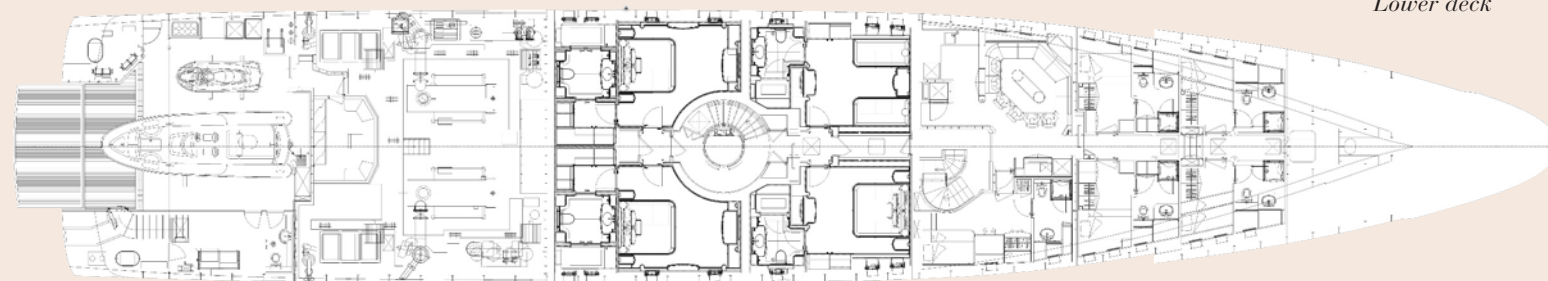

Lower deck

The top deck, which by the Owner's request has become a private deck reserved entirely for him insofar as it can only be reached from the cylindrical central glass elevator with controlled access through a unique pop-up design solution.



TECHNICAL SPECIFICATIONS

Hull	Steel
Superstructure	Aluminium
LOA	60 m / 196.85 ft
Maximum beam	10.60 m / 34.78 ft
Maximum draft	3.0 m / 9.8 ft about
Fuel capacity	120,000.00 Lt / 31,700.65 USG
Fresh water capacity	20,000.00 Lt / 5,283.44 USG
Main Engines	2 x CAT 3512B DITA 1380 bhp @ 1600 rpm
Max speed	16 knots
Cruising speed	15 knots
Range at 12 knots	4800 Nautical miles
Generators	2 x 200 kW Northern Light 1 x 115 kW Northern Light
Bow thruster	160 kW VT Naiad
Stern thruster	Shottel
Stabilisers	2 x Quantum XT zero speed Stab.
Propellers	Five blades Detra
Accommodation	1 Owner apartment. 12 in 3 double cabins 1 twin cabin 1 VIP apartment
Accommodation for Crew	15
Classification	Lloyd's Register
Interior design	Evan K. Marshal
Naval Architecture	Azimut-Benetti S.p.A.
Exterior Styling & Concept	Azimut-Benetti S.p.A.